

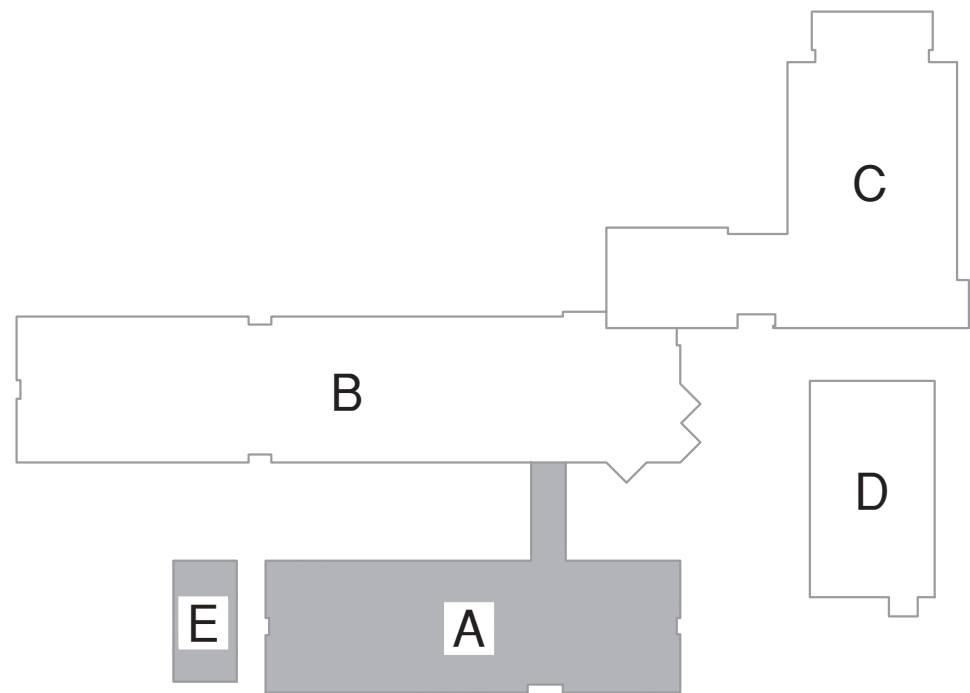

————— EXISTING TO BE REPLACED WITH NEW

- (E1) DISCONNECT AND REMOVE ALL EXISTING LIGHTING FIXTURES. LEGALLY DISPOSE ALL LAMPS AND BALLAST. PROVIDE NEW FIXTURE IN SAME LOCATION. CONNECT TO EXISTING LIGHTING CIRCUIT/WHIP UNLESS NOTED OTHERWISE.
- (E2) ALL EXIT AND EMERGENCY LIGHTING FIXTURES SHALL REMAIN AND ARE NOT INDICATED ON PLAN (UNLESS SPECIFICALLY NOTED ON PLAN TO BE REPLACED).
- (E3) ALL 2X4 LIGHTING FIXTURES INSTALLED IN CEILING GRID SHALL BE INDEPENDENTLY SUPPORTED FROM STRUCTURE.
- (E4) DISCONNECT AND REMOVE EXISTING LINEAR FIXTURES AND REPLACE WITH NEW AT SAME HEIGHT. CONNECT TO EXISTING CIRCUIT.
- (E5) DISCONNECT AND REMOVE EXISTING RECESSED FIXTURE. INSTALL NEW RECESS MOUNTED FIXTURE COMPLETELY COVERING EXISTING OPENING. EXTEND CONDUCTORS TO NEW FIXTURE. PROVIDE CUSTOM TRIM OR MODIFY OPENING AS REQUIRED.
- (E6) REPLACE ANY DAMAGED LAY IN CEILING TILES DUE TO FOR NEW FIXTURE INSTALLATION. NEW TILES SHALL MATCH EXISTING; COORDINATE WITH OWNER.



KEY PLAN



E2

FLOOR PLAN - AREAS A AND E - ELECTRICAL

$$1/8'' = 1'-0''$$

1439 Centre Ct., ste 401
Alexandria, LA 71301
Ph: 318.445.3151
Fx: 318.445.3988
Em: adg@adgllc.net

EMA

EMA Engineering & Consulting, INC.
9941 STEVENS ROAD, SUITE 200
SHREVEPORT, LOUISIANA 71106

318 425 4500
LOUISIANA Registered Engineer (PE #21012)
ICMA Registered Engineer (PE #21012)

5-200-2139-008

SUBMISSION OF BID WILL BE CONSIDERED AN AWARDING NOTICE. THE CONTRACTOR HAS VISITED THE SITE AND HAS VERIFIED ALL EXISTING CONDITIONS AND INCLUDED ANY NECESSARY MODIFICATION TO EXISTING AND NEW CONSTRUCTION DETAILS IN A FORM ASSESSMENT REPORT (FAR) SUBMITTED TO THE CITY.

PHASE 2 - RENOVATIONS TO
CARTER C. RAYMOND
JUNIOR HIGH SCHOOL
2510 SAINT CHARLES AVE, LECOMPTÉ, LA 71346

PROJECT NO: RT
DRAWN: RW
CHECKED:
DATE: 08.08.25
LAST REV:

E-200

© 2006, Alliance Design Group, LLC all rights reserved